

PROJECT NAME:

QUANTITY:

TYPE:

ORDERING CODE:

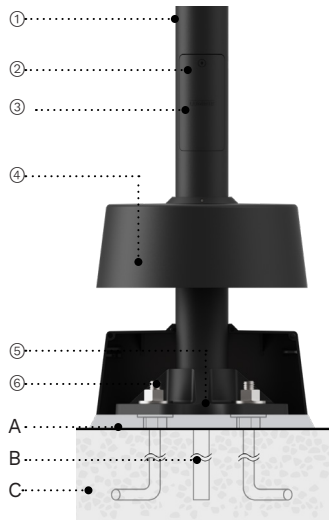

- ① Slim Ø3" (Ø76mm) outside diameter pole, 1/8" (3mm) in wall thickness. Crafted from a sturdy 6061-T6 aluminum alloy extrusion.
- ② Stainless steel hardware.
- ③ Minimalist 2"x4" (51mm X 102mm) cast aluminum wiring access door. Flush mount with the pole and secured by a single screw.
- ④ Aluminum base cover designed with two identical parts, seamlessly assembled without visible screws, 4.8" (122 mm) X Ø12" (305 mm), featuring a stackable design for sustainable transport.
- ⑤ One-piece A356 cast aluminum base with a reinforced design, featuring four integral gussets and a collar insert to maximize pole strength.
- ⑥ Set of (4) 3/4"-10 X 18" lg. X 3" leg. galvanized anchor bolts with a set of (8) 3/4" hot dip galvanized nuts with washers.

NOTES

- A Grout to be packed under pole base to ensure full adherence and stability with footing and prevent loosening of leveling nuts. Provide adequate channel drainage from inside pole (by others).
- B Electrical conduit (by others).
- C Concrete footing (by others).

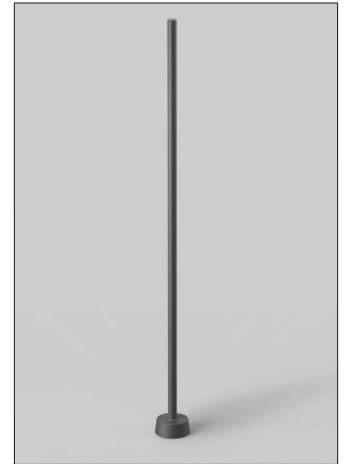

PRS3

MATERIALS

Extruded 6061-T6 aluminum alloy and corrosion resistant A356 aluminum alloy with a copper (CU) content of less than 0.1%.

FINISH

Five-stage preparation process includes preheating of cast aluminum parts for air extraction. Polyester powder coating is applied through an electrostatic process, and oven cured for long term finish.

DESIGN

One of the product's key attributes is its dedicated 3" diameter pole with heights up to 13 feet. Over 90% by weight of the single-head fixture with a 13-foot pole is made of aluminum, a material that is generally recyclable where appropriate facilities are available and accept such items for processing upon proper disassembly at the end of its life.

WARRANTY

5-year limited warranty. This is the only warranty provided and no other statements in this specification sheet create any warranty of any kind. All other express and implied warranties are disclaimed. Complete warranty terms located at: <https://www.acuitybrands.com/support/warranty/terms-and-conditions>

MOUNTING

The cast aluminum base is secured with a set of (4) 3/4"-10 X 18" lg. X 3" leg. galvanized anchor bolts, with a set of (8) 3/4" hot dip galvanized nuts with washers. Anchor can be shipped ahead of time if required. Mounting template will be supplied with order.

MEASUREMENTS

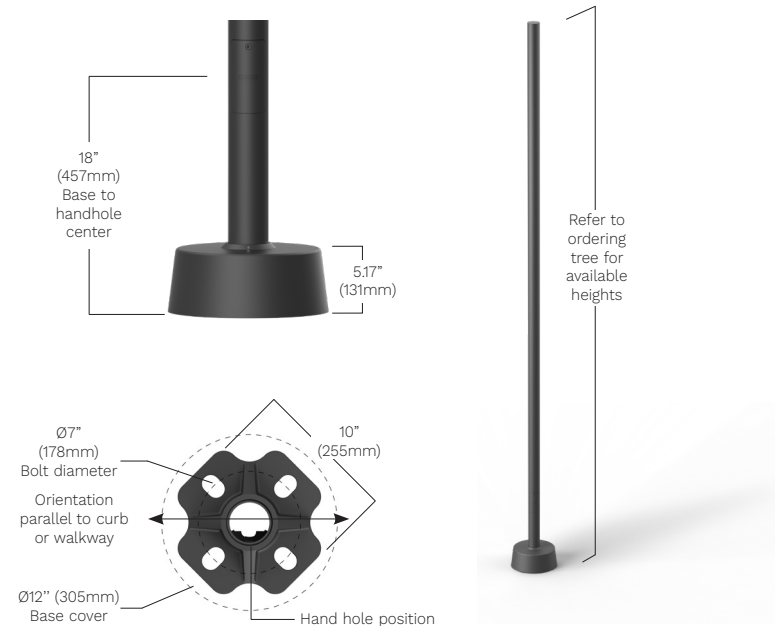

ORDERING CODE

*SERIES	*POLE HEIGHT	*MOUNTED LUMINAIRE	*FINISH	ENVIRONMENT	LESS ANCHOR BOLTS
PRS3 	8FT Pole 8'	TR1 Trilo TR900	BKT Jet black	MG Marine grade paint ³	L/AB Less anchor bolts
	10FT Pole 10'	TR2 Trilo TR902	BZT Bronze		
	12FT Pole 12'		CHT Champagne		
	13FT Pole 13'		DGT Gun metal		
			GRT Titanium gray		
			MST Matte silver		
			SGT Steel gray		
			WHT Snow white		
			CMC Custom matched color ¹		
			RAL RAL color ²		



Must be ordered with Luminis Trilo fixtures
Refer to Trilo spec sheets.

LUMINAIRE CONFIGURATION

*For reference only. Available only with Trilo.

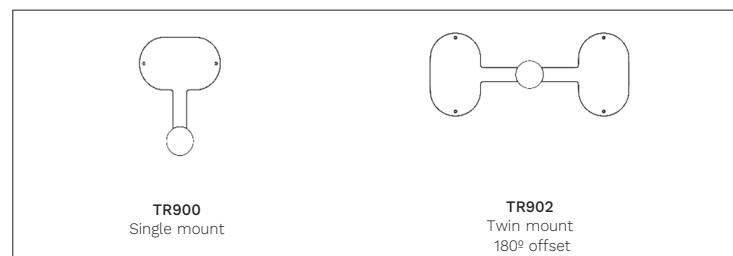

NOTES

*- Denotes a required field

1- Contact factory to coordinate custom matching color.

2- Specify RAL number.

3- Marine grade paint for harsh, coastal environment and exposure to salt water. Additional delay required please contact factory for info.

LUMINIS.COM

Toll free: (866) 586-4647 | Fax: (514) 683-8872 | Email: info@luminis.com

260 Labrosse, Pointe-Claire (QC) Canada H9R 5L5

©2025 Acuity Brands Lighting Canada, Inc. All rights reserved. Specifications subject to change without notice.

EPA RATING

The EPA (Effective Projected Area) is a coefficient used to evaluate the loads induced by the wind on a luminaire. It is calculated by multiplying the drag coefficient and the Frontal Projected Area of a luminaire (maximum achievable cross-sectional area in ft²).

The TOTAL EPA is the combination of the luminaire's EPA and pole's additional components' EPA. It should not exceed the maximum allowable EPA at the selected geographic location and their corresponding wind map.

AASHTO 2013 EPA RATING (FT ²)										
SERIES	POLE HEIGHT (ft)	POLE WEIGHT (lb)	WALL THICKNESS (in)	EPA RATING (PI2)						
				80	90	100	110 (mph)	150	170	180
PRS3	8	15.94	0.125	3	3	2.92	2.85	2.1	1.5	1.33
	10	18.56	0.125	2.25	2.25	2.16	2.02	1.25	-	-
	12	21.21	0.125	1.64	1.64	1.58	1.4	-	-	-
	13	22.53	0.125	1.4	1.4	1.33	1.14	-	-	-

CSA EPA RATING (FT ²)														
SERIES	POLE HEIGHT (ft)	POLE WEIGHT (lb)	WALL THICKNESS (in)	EPA RATING (PI2)										
				200	287	373	460	546	633	719	806	892	979	1065
PRS3	8	15.94	0.125	5.46	3.59	2.52	1.82	1.36	1.06	-	-	-	-	-
	10	18.56	0.125	4.04	2.42	1.59	1.02	-	-	-	-	-	-	-
	12	21.21	0.125	2.91	1.53	-	-	-	-	-	-	-	-	-
	13	22.53	0.125	2.42	1.19	-	-	-	-	-	-	-	-	-